

GENERAL NOTES:

1. A TREE CUTTING PERMIT AND AN EROSION & SEDIMENT CONTROL PERMIT SHALL BE OBTAINED PRIOR TO ANY WORKS COMMENCING ON SITE.
2. TEMPORARY TREE PROTECTION BARRIER FENCES SHALL BE CONSTRUCTED AND INSPECTED BY THE CITY OF SURREY'S PARKS DEPARTMENT AS PER THE LOCATIONS AND INSTRUCTIONS IN THE ARBORIST REPORT AND LANDSCAPING DRAWINGS PRIOR TO ANY WORKS COMMENCING ON SITE.
3. A PLUMBING PERMIT AND ALL OTHER APPLICABLE APPROVALS AND PERMITS SHALL BE OBTAINED PRIOR TO ANY UNDERGROUND CIVIL WORKS COMMENCING ON SITE. THE CONTRACTOR SHALL ARRANGE AND PAY FOR ALL PERMIT FEES FOR OBTAINING THE REQUIRED PERMITS.
4. PRIOR TO CIVIL SITE SERVICES CONSTRUCTION, THE CONTRACTOR SHALL ARRANGE FOR A PRE-CONSTRUCTION MEETING ON SITE WITH CENTRAS ENGINEERING LTD. TO REVIEW AND DISCUSS THE ISSUED FOR CONSTRUCTION CIVIL DRAWINGS, CONSTRUCTION METHODS, GENERAL COORDINATION BETWEEN TRADES, SCHEDULE, TIMING, SITE REVIEWS, TESTING PROCEDURES, TESTING RESULTS, ETC.
5. ALL CONSTRUCTION WORKS SHALL BE COMPLETED IN SUCH A MANNER SO AS TO PREVENT THE RELEASE OF ANY CONSTRUCTION WATER, SILT, CONCRETE LEACHATE AND ANY OTHER DELETERIOUS SUBSTANCES SHALL BE DISPOSED OF OR PLACED IN SUCH A MANNER AS TO PREVENT IT'S ENTRY INTO ANY STORM SEWER SYSTEM OR WATER COURSE.
6. THE DEVELOPER AND CONTRACTOR ARE RESPONSIBLE FOR SWEEPING OF THE EXISTING ROADWAYS FREE OF ANY DIRT AND SEDIMENT CAUSED BY CONSTRUCTION ACTIVITY ON A DAILY BASIS.
7. THE CONTRACTOR SHALL RESTATE ALL DISTURBED WORKS TO PRE-CONSTRUCTION CONDITIONS OR BETTER AND TO CURRENT MMCD AND CITY OF SURREY'S STANDARDS AND TO THE SATISFACTION OF CENTRAS ENGINEERING LTD.
8. ALL NEW ONSITE ELECTRICAL AND TELECOMMUNICATIONS SERVICES AND CONNECTIONS SHALL BE LOCATED UNDERGROUND. REFER TO THE ELECTRICAL SITE PLAN AND BC HYDRO DRAWINGS FOR DETAILS.
9. A MINIMUM OF 48 HOURS NOTICE SHALL BE PROVIDED BY THE CONTRACTOR TO CENTRAS ENGINEERING LTD. PRIOR TO CIVIL CONSTRUCTION COMMENCEMENT.
10. THE CONTRACTOR SHALL COMPLY WITH ALL THE ARBORIST RECOMMENDATIONS IN THE ARBORIST REPORT AND GEOTECHNICAL REPORT.
11. UPON SUBSTANTIAL CONSTRUCTION COMPLETION (WITHIN 30 DAYS), THE CONTRACTOR SHALL PROVIDE CENTRAS ENGINEERING LTD. WITH COMPLETE AS-CONSTRUCTED REDLINE INFORMATION (B.C.L.S. OR P.ENG. CERTIFIED) FOR ALL THE PROPOSED CIVIL WORKS SHOWN ON THESE PLANS.

SITE GRADING NOTES:

1. ALL ONSITE CIVIL WORKS SHALL BE CONSTRUCTED IN ACCORDANCE WITH THE LATEST EDITIONS OF THE BRITISH COLUMBIA'S BUILDING CODES AND PLUMBING CODES, MASTER MUNICIPAL CONSTRUCTION DOCUMENTS (MMCD) PLATINUM EDITION, THE CITY OF SURREY'S DESIGN CRITERIA MANUAL, THE CITY OF SURREY'S STANDARD CONSTRUCTION DOCUMENTS (GENERAL CONDITIONS, SUPPLEMENTARY SPECIFICATIONS AND SUPPLEMENTARY STANDARD DRAWINGS) AND ALL OTHER APPLICABLE MUNICIPAL BYLAWS AND POLICIES, UNLESS NOTED OTHERWISE.
2. ALL DIMENSIONS, OFFSETS, SIZES AND ELEVATIONS ARE METRIC AND TO GEODETIC DATUM, UNLESS NOTED OTHERWISE.
3. ALL BUBBLED ELEVATIONS ARE FINISHED SURFACE PAVEMENT ELEVATIONS.
4. CHANGES IN GRADE LINES SHALL BE FORMED BY SMOOTH CURVES.
5. ADJUST ALL EXISTING AND PROPOSED RIMS, I.C.'S AND COVERS FLUSH WITH FINISHED SURFACE GRADES (UNLESS NOTED OTHERWISE).
6. TIE-IN ALL PROPOSED SURFACE WORKS TO EXISTING SURFACE WORKS WITH A SMOOTH TRANSITION.
7. FINISHED SURFACE ELEVATIONS SHALL BE INSTALLED WITHIN A VERTICAL AND HORIZONTAL TOLERANCE OF 10mm OR THEY ARE SUBJECT TO REMOVAL AND REPLACEMENT AT THE CONTRACTOR'S EXPENSE.
8. REFER TO ARCHITECTURAL PLANS FOR CONCRETE CURBING DETAILS.
9. EXISTING SUB-GRADE SHALL BE PREPARED AS PER GEOTECHNICAL RECOMMENDATIONS AND APPROVED BY THE GEOTECHNICAL ENGINEER PRIOR TO PLACEMENT OF IMPORTED SUB-BASE AND BASE MATERIALS. SUB-BASE AND BASE MATERIALS SHALL BE INSTALLED AND COMPACTED AS PER THE RECOMMENDATIONS IN THE GEOTECHNICAL REPORT AND APPROVED BY THE GEOTECHNICAL ENGINEER PRIOR TO COMMENCING ASPHALT PAVING.
10. ALL LOOSE AND/OR ORGANIC MATERIAL WITHIN THE ROADWAY SHALL BE OVER EXCAVATED AS DIRECTED BY THE GEOTECHNICAL ENGINEER AND SHALL BE REPLACED WITH APPROVED ENGINEERED FILL AS PER GEOTECHNICAL RECOMMENDATIONS AND APPROVAL.
11. REFER TO THE GEOTECHNICAL REPORT AND MMCD SECTION 32 12 16 FOR HOT-MIX ASPHALT PAVEMENT RECOMMENDATIONS SUCH AS MIX DESIGN AND MINIMUM FINISHED PAVEMENT THICKNESS.
12. SURFACE WATER PONDING IS NOT PERMITTED AND IS SUBJECT TO REMOVAL AND REPLACEMENT AT THE CONTRACTOR'S EXPENSE.
13. IF REQUIRED, ASPHALT PAVEMENT CUTS AND PATCHES SHALL CONFORM TO MMCD STANDARD DRAWING NUMBER G5 AND TO CURRENT CITY OF SURREY'S STANDARDS.
14. REFER TO LANDSCAPE DRAWINGS FOR DECORATIVE SURFACE TREATMENT DETAILS AND SPECIFICATIONS. DECORATIVE SURFACE TREATMENTS SHALL MEET H20 TRAFFIC LOADING SPECIFICATIONS.
15. REFER TO ARCHITECTURAL AND/OR LANDSCAPE DRAWINGS FOR DETAILED GRADING AROUND BUILDINGS AND LANDSCAPE AREAS.
16. PRIOR TO INSTALLATION OF CONCRETE CURBING AND HOT-MIX ASPHALT PAVING, THE CONTRACTOR SHALL OBTAIN WRITTEN SIGN OFF APPROVAL FROM THE ELECTRICAL CONSULTANT AND BC HYDRO THAT ALL THE UNDERGROUND ELECTRICAL AND TELECOMMUNICATIONS SERVICES HAVE BEEN INSTALLED AND ARE ACCEPTABLE TO THE ELECTRICAL CONSULTANT AND BC HYDRO.
17. THE DEVELOPER SHALL EMPLOY THE SERVICES OF A GEOTECHNICAL ENGINEER FOR FIELD REVIEWS AND CERTIFICATIONS RELATED TO STRIPPING DEPTHS, SUB-GRADE EXCAVATION, SUB-GRADE PREPARATION, ENGINEERED FILL, BACKFILL MATERIALS WITHIN TRENCHES, SHORING, ROAD STRUCTURE MATERIALS, COMPACTION, ASPHALT MIX DESIGN, ASPHALT CORE TESTING, ASPHALT COMPACTION TESTING, ETC.

LEGEND

- EXISTING GROUND SURFACE ELEVATION.
- EXISTING GROUND SURFACE CONTOUR ELEVATION.
- PROPOSED EXTENT OF TEMPORARY SITE OFFICE TRAILER BUILDING (BY OTHERS).
- ASPHALT PAVEMENT SURFACE AS PER THE GEOTECHNICAL CONSULTANT'S REQUIREMENTS.
- PROPOSED EXTENT OF STORM WATER MANAGEMENT BIOSWALE.
- EXISTING GROUND SURFACE ELEVATION.
- PROPOSED FINISHED SURFACE ELEVATION.
- MEET EXISTING GROUND SURFACE ELEVATION.
- OVERLAND FINISHED SURFACE FLOW DIRECTION.
- PROPOSED CATCH BASIN MANHOLE.
- STORM SEWER
- STORM WATER OIL & GRIT INTERCEPTOR MANHOLE

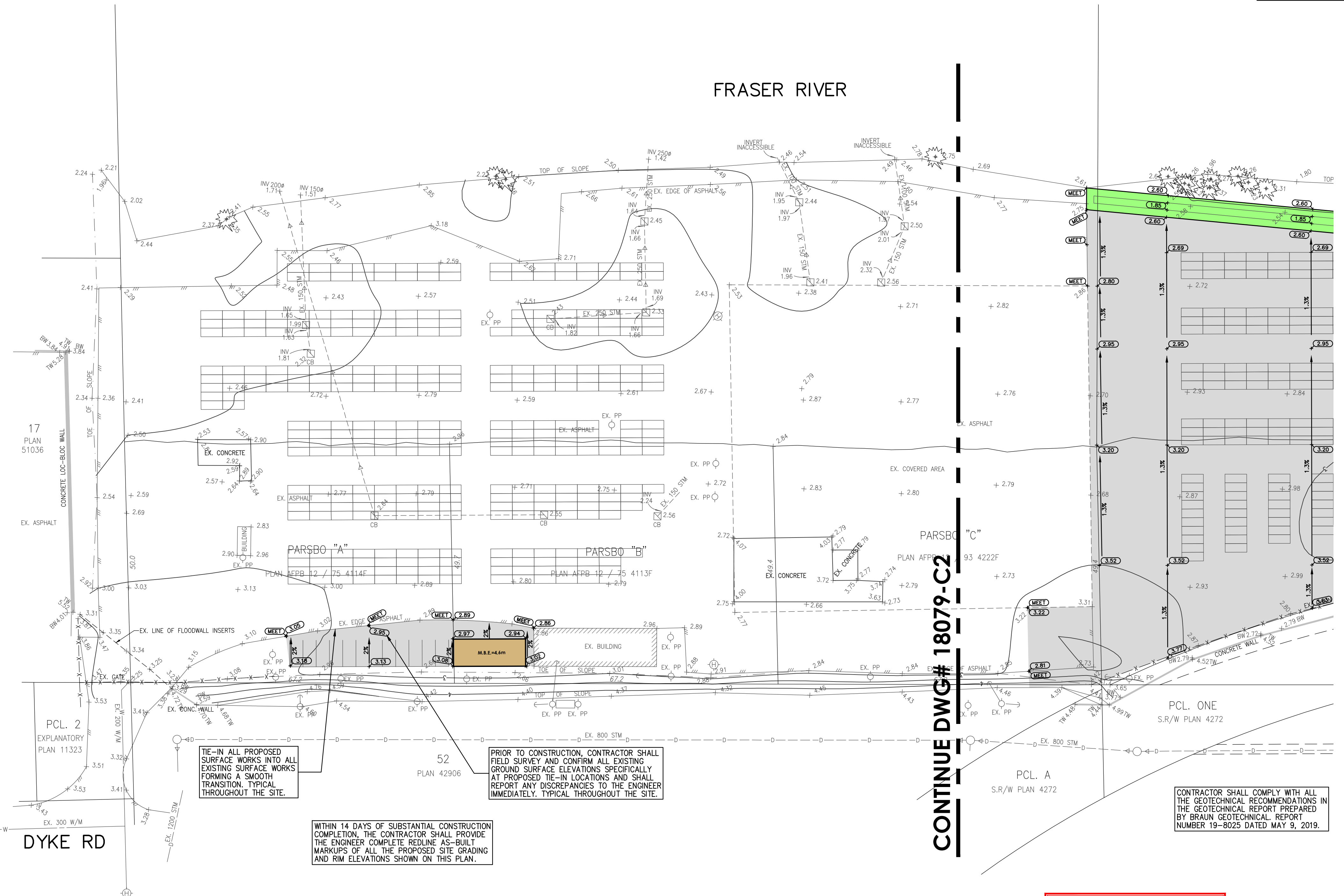

CONTINUE DWG# 18079-C2

NOT FOR CONSTRUCTION

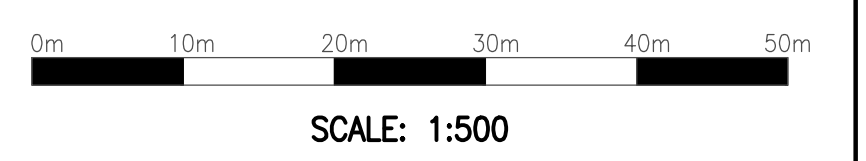

CONTRACTOR SHALL COMPLY WITH ALL THE GEOTECHNICAL RECOMMENDATIONS IN THE GEOTECHNICAL REPORT PREPARED BY BRAUN GEOTECHNICAL REPORT NUMBER 19-8025 DATED MAY 9, 2019.

PRIOR TO CONSTRUCTION, CONTRACTOR SHALL FIELD SURVEY AND CONFIRM ALL EXISTING GROUND SURFACE ELEVATIONS SPECIFICALLY AT PROPOSED TIE-IN LOCATIONS AND SHALL REPORT ANY DISCREPANCIES TO THE ENGINEER IMMEDIATELY. TYPICAL THROUGHOUT THE SITE.

WITHIN 14 DAYS OF SUBSTANTIAL CONSTRUCTION COMPLETION, THE CONTRACTOR SHALL PROVIDE THE ENGINEER COMPLETE REDLINE AS-BUILT MARKUPS OF ALL THE PROPOSED SITE GRADING AND RIM ELEVATIONS SHOWN ON THIS PLAN.

TIE-IN ALL PROPOSED SURFACE WORKS INTO ALL EXISTING SURFACE WORKS FORMING A SMOOTH TRANSITION. TYPICAL THROUGHOUT THE SITE.

C:\Users\Warner\Desktop\Projects\18079\A Drawings\18079-02site (1).dwg (PUBLISH-5) 5/28/2019 2:41PM

BENCHMARK	No.	REVISIONS / SUBMISSIONS	DATE	CLIENT	ENGINEER-OF-RECORD	PROJECT NAME	ENGINEER'S SEAL	CITY OF SURREY				
								SITE GRADING PLAN (SOUTH)				
LEGAL		ALL ELEVATIONS ARE GEODETIC AND REFER TO SURVEY MONUMENT NUMBER: 1277 J LOCATED AT: ON S. END OF PATTULLO BRIDGE AT LAMP STANDARD AND HAVING ELEVATION OF: 12.856m		GOODRICH TERMINAL 9985 GRACE ROAD SURREY, BC V3V 3V7 TEL: 604-588-0132	CENTRAS Engineering Ltd CROYDON BUSINESS CENTRE #216-2630 CROYDON DRIVE SURREY, BC V3S 6T3 PH: 604-782-6927 EMAIL: info@centras.ca	OUTDOOR LUMBER STORAGE YARD PROJECT SITE ADDRESS 10880 DYKE RD AND 21780 SOUTH WESTMINSTER SHORE, SURREY, BC	May 28, 2019	DESIGN:	SBO	DRAWING NUMBER	18079-C1	REV. 0
	DRAWN:	SBO	HOR. SCALE					1:500				
			MAY 5, 2019					ENGINEER:	SBO	VER. SCALE		

DESTROY ALL PRINTS BEARING PREVIOUS REVISION NUMBER

