

**LEGEND**

	Railway
	Site Boundary
	Existing Structure
	Property Boundary
	Lot 2
	Lot 3
	Lot 4
	Lot 5
	Lot 6

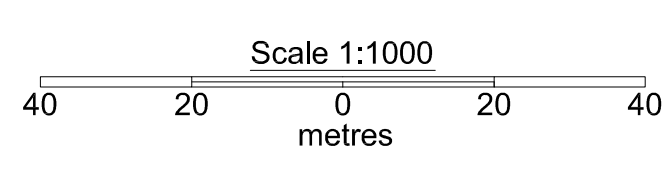

<b>Title:</b> LOTS AND CURRENT SITE USE	
<b>Project:</b> DATA GAP ANALYSIS SURREY-BROWNSVILLE, SURREY, BC	
<b>Client:</b> VANCOUVER FRASER PORT AUTHORITY	
	<b>Date:</b> MAY 2013
<b>FIGURE 2A</b>	

APEC	Description
1	Former Leckie JW Co. Tannery
2	Lumber Storage Area
3	Plant AST in the east central portion of the main building
4	Former Mill Service Shop
5	Waste Oil AST outside the Mill Service Shop
6	Former Fueling Facility
7	Main Building lumber storage, packaging application of PCP
8	Septic USTs
9	Former Lumber Storage Area
10	Gasoline UST
11	Waste Oil AST
12	Disposed Area for Hydraulic In-ground Hoists
13	Former Green Chain and Planer Mill
14	Former Chlorophenol Dip Tank (location of former hydraulic hoists)
15	Wood Chip and Wood Debris Area
16	Area of Mineral Oil and Grease above Level C in soil identified by SPQR
17	Auto Wrecking Yard on Timberland Rd
18	Rybak Aluminum Recycling Ltd.
19	Former Kiln A - Lot 3 (South)
20	Former Kiln - Lot 5
21	Oil Storage Shed - Lot 6
22	Former Kiln - Lot 6
23	Former Green Chain - Lot 6
24	Former PCP Spray Tank, Spray Area and Lumber Storage
25	Lumber Storage Area - Lot 6
26	Fill - Lot 2/4
27	Historical Chromium-impacted Soil Stockpile on Lots 2/4
28	Fill - Lot 3
29	Fill - Lot 5
30	Fill - Lot 6
31	Lumber Storage Area - Lot 5
32	Former Kiln B - Lot 3 (North)
33	Diesel Spill - Railway
34	VRH and LEPH Plume by Warehouse - Lot 6

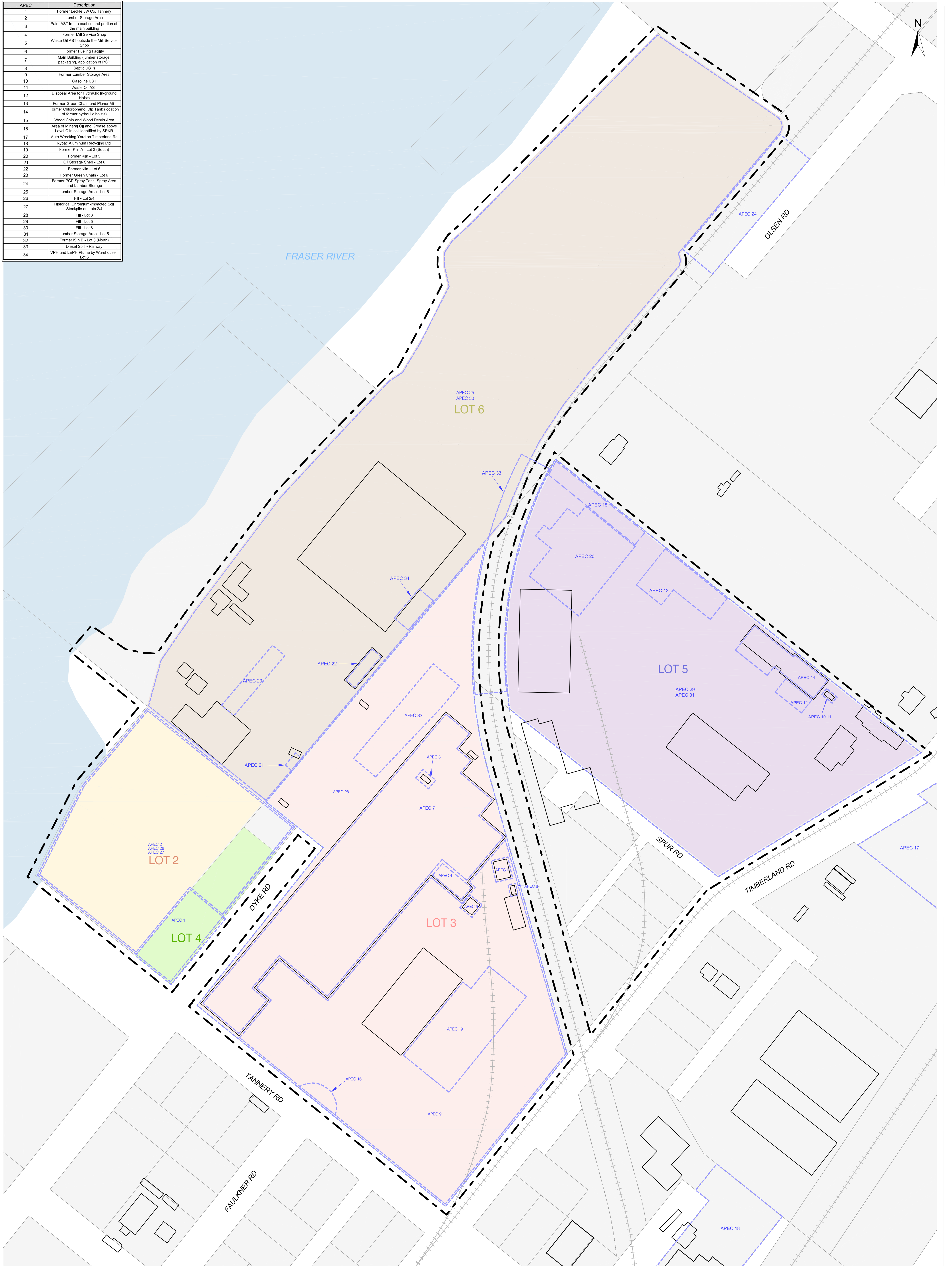

**LEGEND**

	Area of Potential Environmental Concern (APEC)		Lot 2
	Railway		Lot 3
	Site Boundary		Lot 4
	Existing Structure		Lot 5
	Property Boundary		Lot 6

<b>Title:</b> LOTS AND AREAS OF POTENTIAL ENVIRONMENTAL CONCERN	
<b>Project:</b> DATA GAP ANALYSIS SURREY-BROWNSVILLE, SURREY, BC	
<b>Client:</b> VANCOUVER FRASER PORT AUTHORITY	
	<b>Date:</b> MAY 2013
<b>FIGURE 2B</b>	

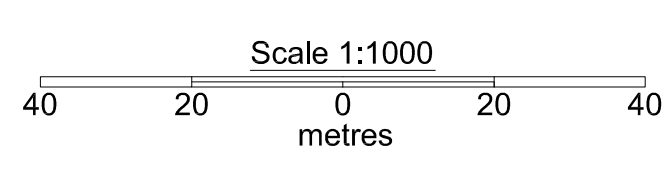

APEC	Description
1	Former Leckie JW Co. Tannery
2	Lumber Storage Area
3	Paint AST in the east corner portion of the main building
4	Former Mill Service Shop
5	Waste Oil AST outside the Mill Service Shop
6	Former Fueling Facility
7	Main Building (lumber storage, packaging, application of PCP)
8	Septic USTs
9	Former Lumber Storage Area
10	Gasoline UST
11	Waste Oil AST
12	Disposal Area for Hydraulic In-ground Hoists
13	Former Green Chain and Planer Mill
14	Former Chlorophenol Dip Tank (location of former hydraulic hoists)
15	Wood Chips and Wood Debris Area
16	Area of Mineral Oil and Grease above Level C in soil identified by SROR
17	Auto Wrecking Yard on Timberland Rd
18	Rypac Aluminum Recycling Ltd
19	Former K&H A - Lot 3 (South)
20	Former K&H - Lot 5
21	Oil Storage Shed - Lot 6
22	Former K&H - Lot 6
23	Former Green Chain - Lot 6
24	Former PCP Spray Tank, Spray Area and Lumber Storage
25	Lumber Storage Area - Lot 6
26	FB - Lot 2/4
27	Historical Chromium-impacted Soil Spoils on Lots 2/4
28	FB - Lot 3
29	FB - Lot 5
30	FB - Lot 6
31	Lumber Storage Area - Lot 5
32	Former K&H B - Lot 3 (North)
33	Diesel Spill - Railway
34	VPH and LEPH Plume by Warehouse - Lot 6

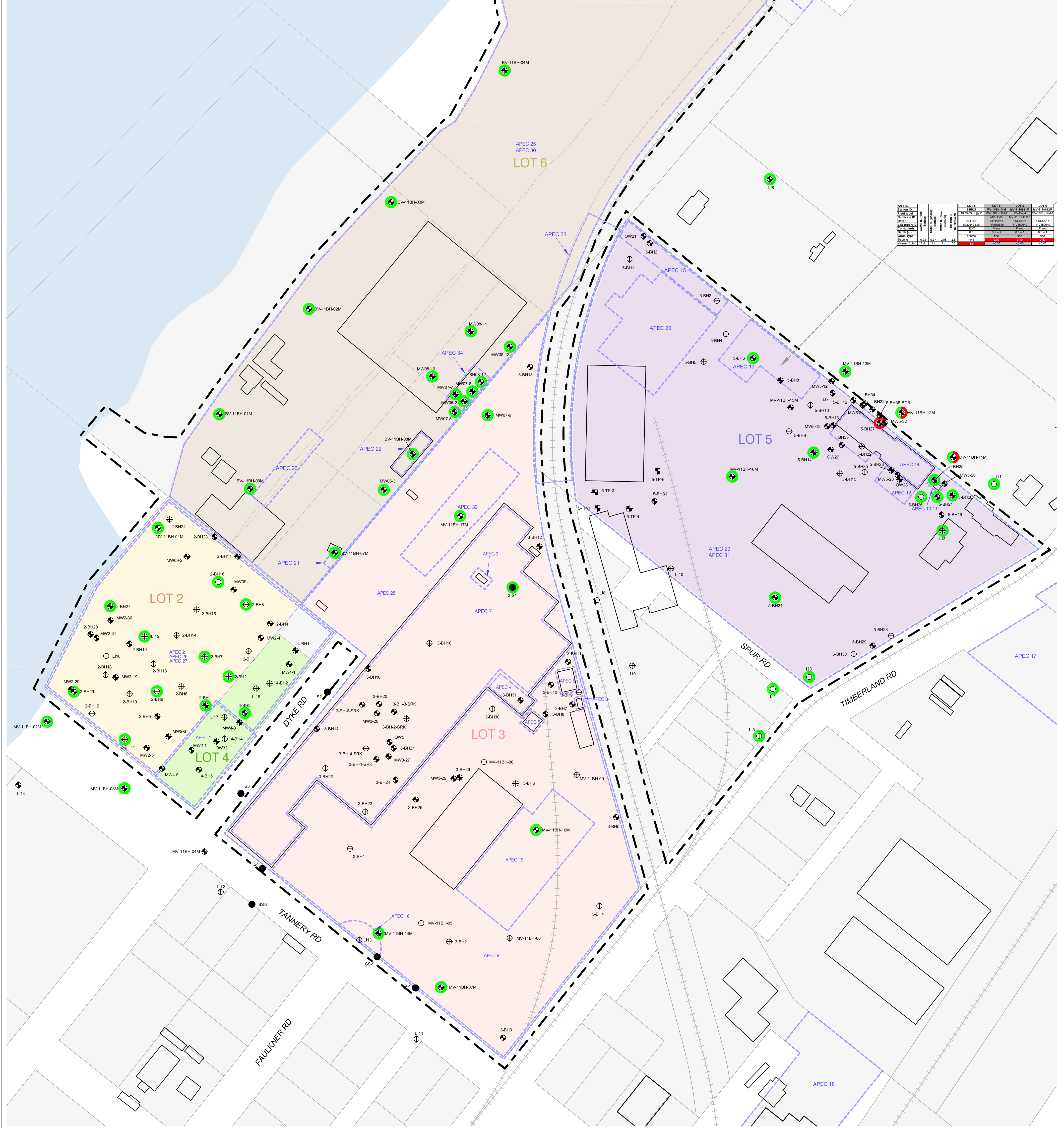

Area ID	Area Name	Area Type	Area Code	Area Status	Area Date	Area Description
1	LOT 2	Area of Potential Environmental Concern	2	Active	2012-11-09	Historical Chromium-impacted Soil Spoils on Lots 2/4
2	LOT 3	Area of Potential Environmental Concern	3	Active	2012-11-09	Former K&H A - Lot 3 (South)
3	LOT 4	Area of Potential Environmental Concern	4	Active	2012-11-09	Former K&H - Lot 5
4	LOT 5	Area of Potential Environmental Concern	5	Active	2012-11-09	Former K&H B - Lot 3 (North)
5	LOT 6	Area of Potential Environmental Concern	6	Active	2012-11-09	Former K&H A - Lot 3 (South)

**LEGEND**

- Area of Potential Environmental Concern (APEC)
- Railway
- Site Boundary
- Existing Structure
- Property Boundary
- Test Pit
- Borehole
- Monitoring Well
- Surface Soil Sample

● One or more analytical parameters are greater than the applicable BC CSR Soil Standards  
● All analytical parameters are less than the applicable BC CSR Soil Standards  
● One or more analytical parameters are greater than the applicable CCME Soil Standards  
● All analytical parameters are less than the applicable CCME Soil Standards

■ Lot 2  
■ Lot 3  
■ Lot 4  
■ Lot 5  
■ Lot 6

**NOTES**

- All units in ug/g.
- "-" indicates that there is no applicable standard or analyses were not performed.
- Red cells indicates parameter exceeds CCME IL (Fine, Surface). (Current as of 9-November-2012)
- Bold indicates parameter exceeds CCME IL (Coarse, Surface). (Current as of 9-November-2012) - Coloured rings represent most recent sampling date.
- Underline indicates parameter exceeds CCME IL (Fine, Subsoil). (Current as of 9-November-2012)
- Refer to Tables for Full Soil Results.

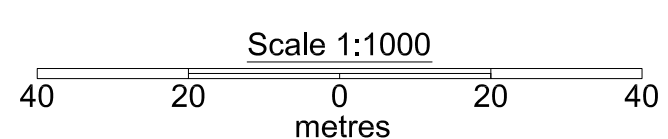

Title: **ANALYTICAL RESULTS - MAHs IN SOIL**

Project: **DATA GAP ANALYSIS SURREY-BROWNSVILLE, SURREY, BC**

Client: **VANCOUVER FRASER PORT AUTHORITY**

Date: **MAY 2013**

**FIGURE 3**

FRANZ ENVIRONMENTAL INC.  
CONSULTING • ENGINEERING • TECHNOLOGIES

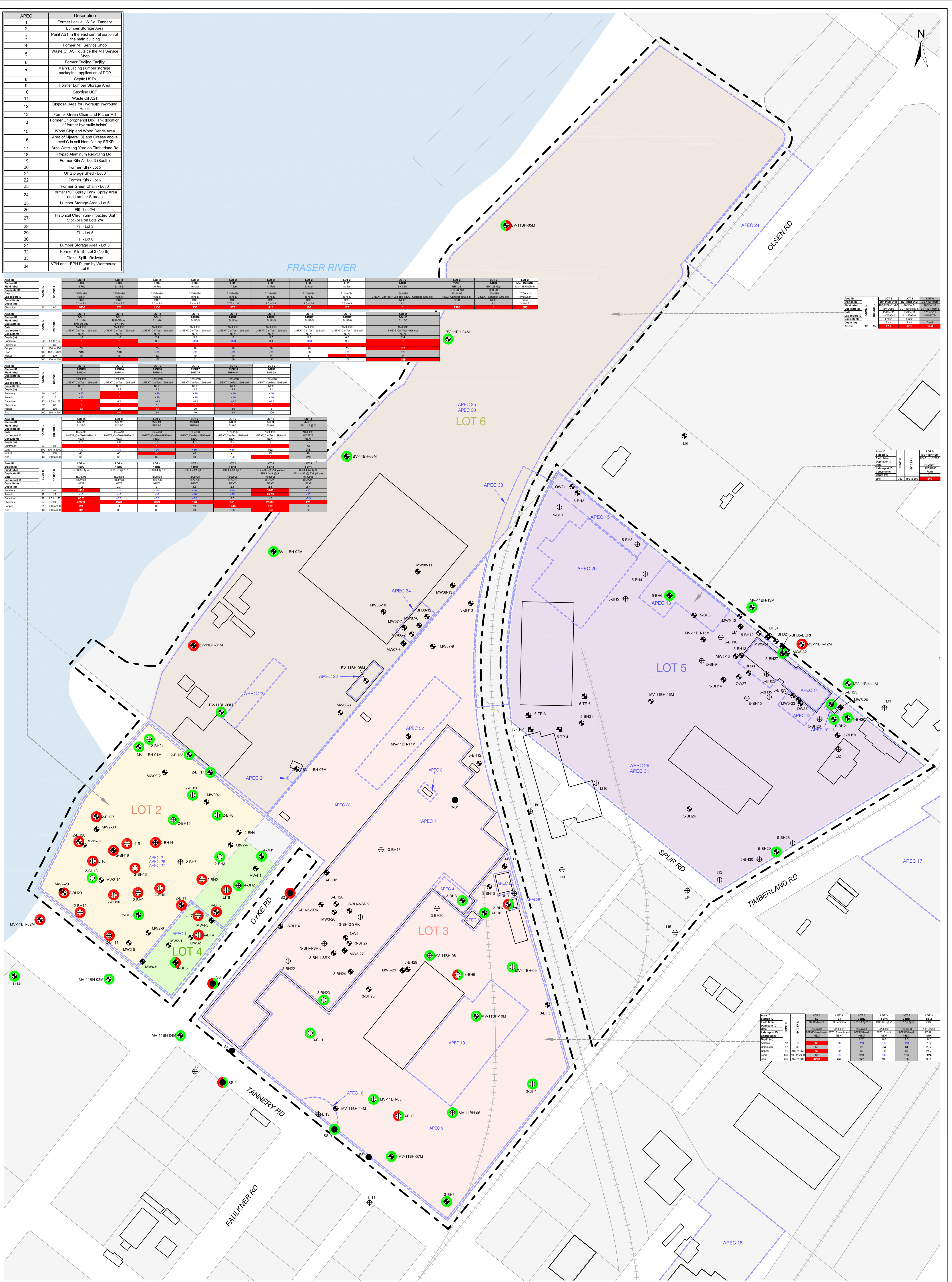

APEC	Description
1	Former Leckie JW Co. Tannery
2	Lumber Storage Area
3	Paint AST in the east corner portion of the main building
4	Former Mill Service Shop
5	Waste Oil AST outside the Mill Service Shop
6	Former Fueling Facility
7	Main Building (lumber storage, packaging, application of PCP)
8	Septic USTs
9	Former Lumber Storage Area
10	Gastrolux UST
11	Waste Oil AST
12	Disposal Area for Hydraulic In-ground Hoses
13	Former Green Chain and Planer Mill
14	Former Chlorophenol Dip Tank (location of former hydraulic hoses)
15	Wood Chips and Wood Debris Area
16	Area of Mineral Oil and Grease above Level C in soil identified by SROR
17	Auto Wrecking Yard on Timberland Rd
18	Rypac Aluminum Recycling Ltd
19	Former K&H A - Lot 3 (South)
20	Former K&H - Lot 5
21	Oil Storage Shed - Lot 6
22	Former K&H - Lot 6
23	Former Green Chain - Lot 6
24	Former PCP Spray Tank, Spray Area and Lumber Storage
25	Lumber Storage Area - Lot 6
26	FB - Lot 2/4
27	Historical Chromium-impacted Soil (topology on Lots 2/4)
28	FB - Lot 3
29	FB - Lot 5
30	FB - Lot 6
31	Lumber Storage Area - Lot 5
32	Former K&H B - Lot 3 (North)
33	Diesel Spill - Railway
34	VPH and LEPH Plume by Warehouse - Lot 6

Area ID	Station ID	Depth (m)	Lot 2	Lot 3	Lot 4	Lot 5	Lot 6
Area 2	Station 2	1.0	10.0	10.0	10.0	10.0	10.0
Area 2	Station 2	1.5	10.0	10.0	10.0	10.0	10.0
Area 2	Station 2	2.0	10.0	10.0	10.0	10.0	10.0
Area 2	Station 2	2.5	10.0	10.0	10.0	10.0	10.0
Area 2	Station 2	3.0	10.0	10.0	10.0	10.0	10.0
Area 2	Station 2	3.5	10.0	10.0	10.0	10.0	10.0
Area 2	Station 2	4.0	10.0	10.0	10.0	10.0	10.0
Area 2	Station 2	4.5	10.0	10.0	10.0	10.0	10.0
Area 2	Station 2	5.0	10.0	10.0	10.0	10.0	10.0
Area 2	Station 2	5.5	10.0	10.0	10.0	10.0	10.0
Area 2	Station 2	6.0	10.0	10.0	10.0	10.0	10.0
Area 2	Station 2	6.5	10.0	10.0	10.0	10.0	10.0
Area 2	Station 2	7.0	10.0	10.0	10.0	10.0	10.0
Area 2	Station 2	7.5	10.0	10.0	10.0	10.0	10.0
Area 2	Station 2	8.0	10.0	10.0	10.0	10.0	10.0
Area 2	Station 2	8.5	10.0	10.0	10.0	10.0	10.0
Area 2	Station 2	9.0	10.0	10.0	10.0	10.0	10.0
Area 2	Station 2	9.5	10.0	10.0	10.0	10.0	10.0
Area 2	Station 2	10.0	10.0	10.0	10.0	10.0	10.0

Area ID	Station ID	Depth (m)	Lot 2	Lot 3	Lot 4	Lot 5	Lot 6
Area 2	Station 2	1.0	10.0	10.0	10.0	10.0	10.0
Area 2	Station 2	1.5	10.0	10.0	10.0	10.0	10.0
Area 2	Station 2	2.0	10.0	10.0	10.0	10.0	10.0
Area 2	Station 2	2.5	10.0	10.0	10.0	10.0	10.0
Area 2	Station 2	3.0	10.0	10.0	10.0	10.0	10.0
Area 2	Station 2	3.5	10.0	10.0	10.0	10.0	10.0
Area 2	Station 2	4.0	10.0	10.0	10.0	10.0	10.0
Area 2	Station 2	4.5	10.0	10.0	10.0	10.0	10.0
Area 2	Station 2	5.0	10.0	10.0	10.0	10.0	10.0
Area 2	Station 2	5.5	10.0	10.0	10.0	10.0	10.0
Area 2	Station 2	6.0	10.0	10.0	10.0	10.0	10.0
Area 2	Station 2	6.5	10.0	10.0	10.0	10.0	10.0
Area 2	Station 2	7.0	10.0	10.0	10.0	10.0	10.0
Area 2	Station 2	7.5	10.0	10.0	10.0	10.0	10.0
Area 2	Station 2	8.0	10.0	10.0	10.0	10.0	10.0
Area 2	Station 2	8.5	10.0	10.0	10.0	10.0	10.0
Area 2	Station 2	9.0	10.0	10.0	10.0	10.0	10.0
Area 2	Station 2	9.5	10.0	10.0	10.0	10.0	10.0
Area 2	Station 2	10.0	10.0	10.0	10.0	10.0	10.0

Area ID	Station ID	Depth (m)	Lot 2	Lot 3	Lot 4	Lot 5	Lot 6
Area 2	Station 2	1.0	10.0	10.0	10.0	10.0	10.0
Area 2	Station 2	1.5	10.0	10.0	10.0	10.0	10.0
Area 2	Station 2	2.0	10.0	10.0	10.0	10.0	10.0
Area 2	Station 2	2.5	10.0	10.0	10.0	10.0	10.0
Area 2	Station 2	3.0	10.0	10.0	10.0	10.0	10.0
Area 2	Station 2	3.5	10.0	10.0	10.0	10.0	10.0
Area 2	Station 2	4.0	10.0	10.0	10.0	10.0	10.0
Area 2	Station 2	4.5	10.0	10.0	10.0	10.0	10.0
Area 2	Station 2	5.0	10.0	10.0	10.0	10.0	10.0
Area 2	Station 2	5.5	10.0	10.0	10.0	10.0	10.0
Area 2	Station 2	6.0	10.0	10.0	10.0	10.0	10.0
Area 2	Station 2	6.5	10.0	10.0	10.0	10.0	10.0
Area 2	Station 2	7.0	10.0	10.0	10.0	10.0	10.0
Area 2	Station 2	7.5	10.0	10.0	10.0	10.0	10.0
Area 2	Station 2	8.0	10.0	10.0	10.0	10.0	10.0
Area 2	Station 2	8.5	10.0	10.0	10.0	10.0	10.0
Area 2	Station 2	9.0	10.0	10.0	10.0	10.0	10.0
Area 2	Station 2	9.5	10.0	10.0	10.0	10.0	10.0
Area 2	Station 2	10.0	10.0	10.0	10.0	10.0	10.0

**LEGEND**

- Area of Potential Environmental Concern (APEC)
- Railway
- Site Boundary
- Existing Structure
- Property Boundary
- Test Pit
- Borehole
- Monitoring Well
- Surface Soil Sample

- One or more analytical parameters are greater than the applicable BC CSR Soil Standards
- All analytical parameters are less than the applicable BC CSR Soil Standards
- One or more analytical parameters are greater than the applicable CCME Soil Standards
- All analytical parameters are less than the applicable CCME Soil Standards

**NOTES**

- All units in ug/g.
- "-" indicates that there is no applicable standard or analyses were not performed.
- Red cells indicates parameter exceeds CCME IL. (Current as of 13-November-2012).
- Bold indicates parameter exceeds BC CSR IL. (Current as of 13-November-2012)
- Coloured rings represent most recent sampling date.
- Black stations were not tested for parameters presented in current drawing.
- Refer to Tables for Full Soil Results.

**Scale 1:1000**

**Title:** ANALYTICAL RESULTS - METALS IN SOIL

**Project:** DATA GAP ANALYSIS SURREY-BROWNSVILLE, SURREY, BC

**Client:** VANCOUVER FRASER PORT AUTHORITY

**Date:** MAY 2013

**FIGURE 4**



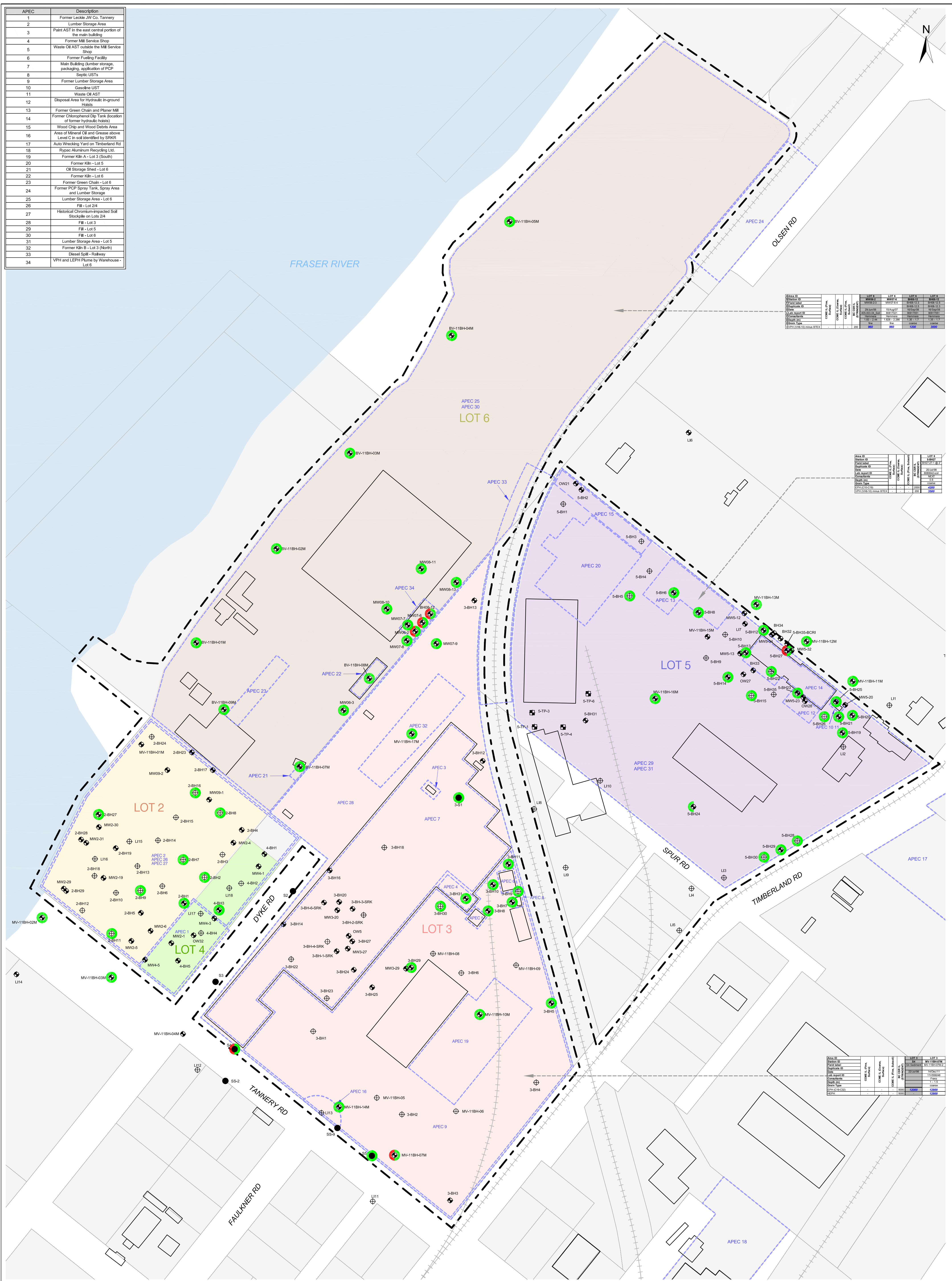

APEC	Description
1	Former Leckie JW Co. Tannery
2	Lumber Storage Area
3	Paint AST in the east corner portion of the main building
4	Former Mill Service Shop
5	Waste Oil AST outside the Mill Service Shop
6	Former Fueling Facility
7	Main Building (lumber storage, packaging, application of PCP)
8	Septic USTs
9	Former Lumber Storage Area
10	Gasoline UST
11	Waste Oil AST
12	Deposit Area for Hydraulic In-ground Hoists
13	Former Green Chain and Planer Mill
14	Former Chlorophenol Dip Tank (location of former hydraulic hoists)
15	Wood Chips and Wood Debris Area
16	Area of Mineral Oil and Grease above Level C in soil identified by SROR
17	Auto Wrecking Yard on Timberland Rd
18	Rypac Aluminum Recycling Ltd
19	Former Kib A - Lot 3 (South)
20	Former Kib - Lot 5
21	Oil Storage Shed - Lot 6
22	Former Kib - Lot 6
23	Former Green Chain - Lot 6
24	Former PCP Spray Tank, Spray Area and Lumber Storage
25	Lumber Storage Area - Lot 6
26	FB - Lot 2/4
27	Historical Chromium-impacted Soil Spoils on Lots 2/4
28	FB - Lot 3
29	FB - Lot 5
30	FB - Lot 6
31	Lumber Storage Area - Lot 5
32	Former Kib B - Lot 3 (North)
33	Diesel Spill - Railway
34	VPH and LEPH Plume by Warehouse - Lot 6

Area ID	Station ID	Depth (m)	Depth (ft)	Depth (m)	Depth (ft)	Depth (m)	Depth (ft)	Depth (m)	Depth (ft)
LOT 2	MW2-30	0.30	1.0	0.30	1.0	0.30	1.0	0.30	1.0
LOT 3	MW3-20	0.30	1.0	0.30	1.0	0.30	1.0	0.30	1.0
LOT 4	MW4-5	0.30	1.0	0.30	1.0	0.30	1.0	0.30	1.0
LOT 5	MW5-12	0.30	1.0	0.30	1.0	0.30	1.0	0.30	1.0
LOT 6	MW6-11	0.30	1.0	0.30	1.0	0.30	1.0	0.30	1.0

Area ID	Station ID	Depth (m)	Depth (ft)	Depth (m)	Depth (ft)	Depth (m)	Depth (ft)	Depth (m)	Depth (ft)
LOT 2	MW2-29	0.30	1.0	0.30	1.0	0.30	1.0	0.30	1.0
LOT 3	MW3-27	0.30	1.0	0.30	1.0	0.30	1.0	0.30	1.0
LOT 4	MW4-6	0.30	1.0	0.30	1.0	0.30	1.0	0.30	1.0
LOT 5	MW5-13	0.30	1.0	0.30	1.0	0.30	1.0	0.30	1.0
LOT 6	MW6-10	0.30	1.0	0.30	1.0	0.30	1.0	0.30	1.0

Area ID	Station ID	Depth (m)	Depth (ft)	Depth (m)	Depth (ft)	Depth (m)	Depth (ft)	Depth (m)	Depth (ft)
LOT 2	MW2-31	0.30	1.0	0.30	1.0	0.30	1.0	0.30	1.0
LOT 3	MW3-28	0.30	1.0	0.30	1.0	0.30	1.0	0.30	1.0
LOT 4	MW4-7	0.30	1.0	0.30	1.0	0.30	1.0	0.30	1.0
LOT 5	MW5-14	0.30	1.0	0.30	1.0	0.30	1.0	0.30	1.0
LOT 6	MW6-12	0.30	1.0	0.30	1.0	0.30	1.0	0.30	1.0

**LEGEND**

- Area of Potential Environmental Concern (APEC)
- Railway
- Site Boundary
- Existing Structure
- Property Boundary
- Test Pit
- Borehole
- Monitoring Well
- Surface Soil Sample

● One or more analytical parameters are greater than the applicable BC CSR Soil Standards  
● All analytical parameters are less than the applicable BC CSR Soil Standards  
● One or more analytical parameters are greater than the applicable CCME Soil Standards  
● All analytical parameters are less than the applicable CCME Soil Standards

■ Lot 2  
■ Lot 3  
■ Lot 4  
■ Lot 5  
■ Lot 6

**NOTES**

- All units in ug/g.
- "-" indicates that there is no applicable standard or analyses were not performed.
- Red cells indicates parameter exceeds CCME IL (Fine, Surface) (Current as of 9-November-2012)
- Bold indicates parameter exceeds CCME IL (Coarse, Surface) (Current as of 9-November-2012)
- Underline indicates parameter exceeds CCME IL (Fine, Subsoil) (Current as of 9-November-2012)
- Coloured rings represent most recent sampling date.
- Refer to Tables for Full Soil Results.

Scale 1:1000

40 20 0 20 40 metres

Title: **ANALYTICAL RESULTS - PHCs IN SOIL**

Project: **DATA GAP ANALYSIS SURREY-BROWNSVILLE, SURREY, BC**

Client: **VANCOUVER FRASER PORT AUTHORITY**

Date: **MAY 2013**

**FIGURE 6**

FRANZ ENVIRONMENTAL INC. CONSULTING • ENGINEERING • TECHNOLOGIES

APEC	Description
1	Former Leckie JW Co. Tannery
2	Lumber Storage Area
3	Paint AST in the east corner portion of the main building
4	Former Mill Service Shop
5	Waste Oil AST outside the Mill Service Shop
6	Former Fueling Facility
7	Main Building (lumber storage, packaging, application of PCP)
8	Septic USTs
9	Former Lumber Storage Area
10	Gasoline UST
11	Waste Oil AST
12	Disposal Area for Hydraulic In-ground Hoses
13	Former Green Chain and Planer Mill
14	Former Chlorophenol Dip Tank (location of former hydraulic hoses)
15	Wood Chips and Wood Debris Area
16	Area of Mineral Oil and Grease above Level C in soil identified by SROR
17	Auto Wrecking Yard on Timberland Rd
18	Rypac Aluminium Recycling Ltd
19	Former K&H A - Lot 3 (South)
20	Former K&H - Lot 5
21	Oil Storage Shed - Lot 6
22	Former K&H - Lot 6
23	Former Green Chain - Lot 6
24	Former PCP Spray Tank, Spray Area and Lumber Storage
25	Lumber Storage Area - Lot 6
26	FB - Lot 2/4
27	Historical Chromium-impacted Soil Spill on Lots 2/4
28	FB - Lot 3
29	FB - Lot 5
30	FB - Lot 6
31	Lumber Storage Area - Lot 5
32	Former K&H B - Lot 3 (North)
33	Diesel Spill - Railway
34	VPH and LEPH Plume by Warehouse - Lot 6

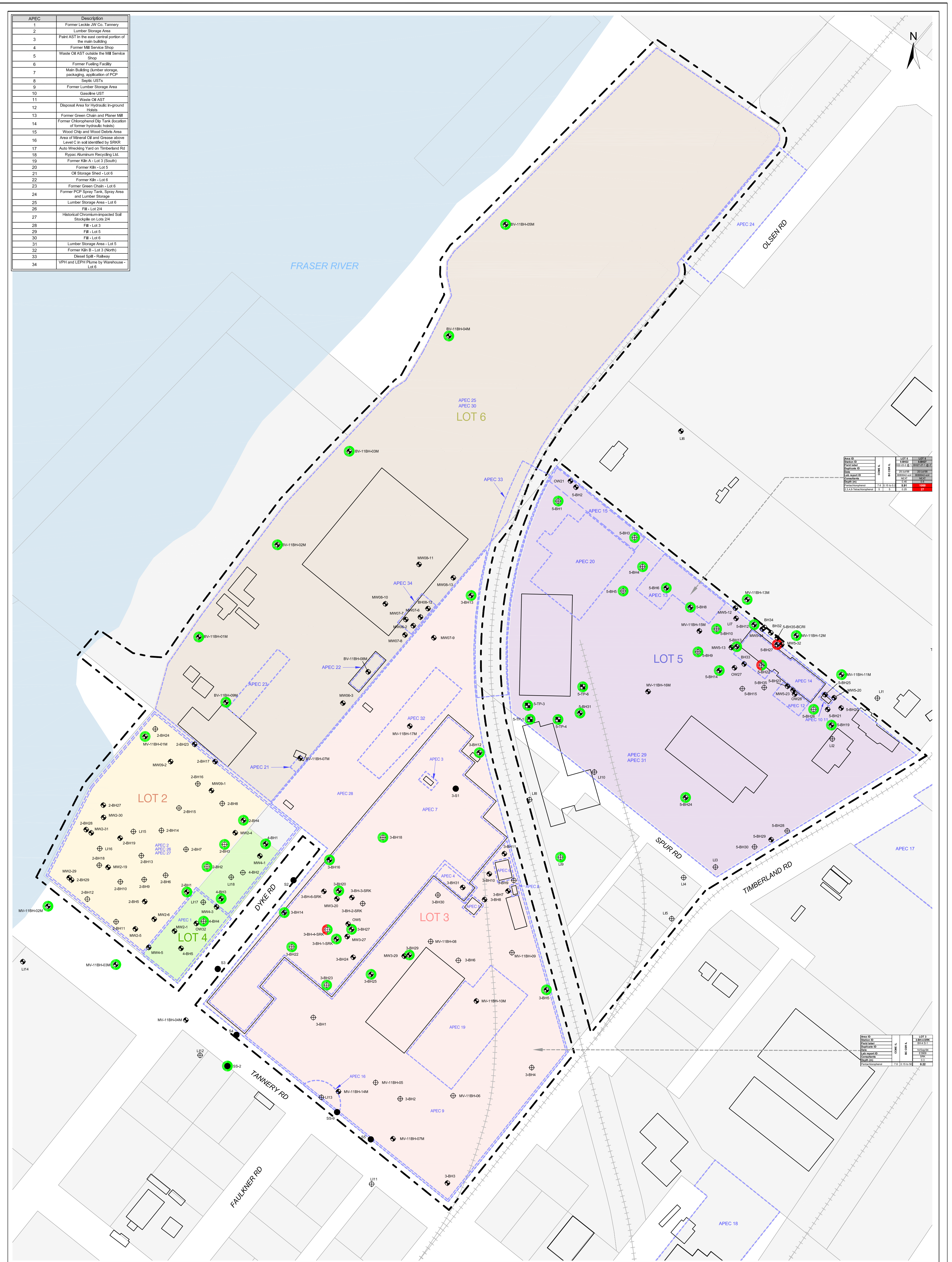

LEGEND	
	Area of Potential Environmental Concern (APEC)
	Railway
	Site Boundary
	Existing Structure
	Property Boundary
	Test Pit
	Borehole
	Monitoring Well
	Surface Soil Sample
	One or more analytical parameters are greater than the applicable BC CSR Soil Standards
	All analytical parameters are less than the applicable BC CSR Soil Standards
	One or more analytical parameters are greater than the applicable CCME Soil Standards
	All analytical parameters are less than the applicable CCME Soil Standards
	Lot 2
	Lot 3
	Lot 4
	Lot 5
	Lot 6

**NOTES**  
- All units in ug/g.  
- "-" indicates that there is no applicable standard or analyses were not performed.  
- Red cells indicates parameter exceeds CCME IL. (Current as of 9-November-2012)  
- Bold indicates parameter exceeds BC CSR IL. (Current as of 9-November-2012)  
- Coloured rings represent most recent sampling date.  
- Refer to Tables for Full Soil Results.

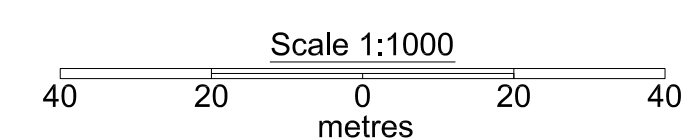

Title: **ANALYTICAL RESULTS - PHENOLS/CHLOROPHENOLS IN SOIL**

Project: **DATA GAP ANALYSIS SURREY-BROWNSVILLE, SURREY, BC**

Client: **VANCOUVER FRASER PORT AUTHORITY**

Date: **MAY 2013**

**FIGURE 7**

FRANZ ENVIRONMENTAL INC. CONSULTING • ENGINEERING • TECHNOLOGIES

APEC	Description
1	Former Leckie JW Co. Tannery
2	Lumber Storage Area
3	Plant AST in the east central portion of the main building
4	Former Mill Service Shop
5	Waste Oil AST outside the Mill Service Shop
6	Former Fueling Facility
7	Main Building Lumber storage, packaging application of PCP
8	Septic USTs
9	Former Lumber Storage Area
10	Gasoline UST
11	Waste Oil AST
12	Disposed Area for Hydraulic In-ground Hoists
13	Former Green Chain and Planer Mill
14	Former Chlorophenol Dip Tank (location of former hydraulic hoists)
15	Wood Chip and Wood Debris Area
16	Area of Mineral Oil and Grease above Level C in soil identified by SPQR
17	Auto Wrecking Yard on Timberland Rd
18	Ryback Aluminum Recycling Lot
19	Former Kih A - Lot 3 (South)
20	Former Kih - Lot 5
21	Oil Storage Shed - Lot 6
22	Former Kih - Lot 6
23	Former Green Chain - Lot 6
24	Former PCP Spray Tank, Spray Area and Lumber Storage
25	Lumber Storage Area - Lot 6
26	Fill - Lot 2/4
27	Historical Chromium-impacted Soil Stockpile on Lots 2/4
28	Fill - Lot 3
29	Fill - Lot 5
30	Fill - Lot 6
31	Lumber Storage Area - Lot 5
32	Former Kih B - Lot 3 (North)
33	Diesel Spill - Railway
34	VRH and LEPH Plume by Warehouse - Lot 6

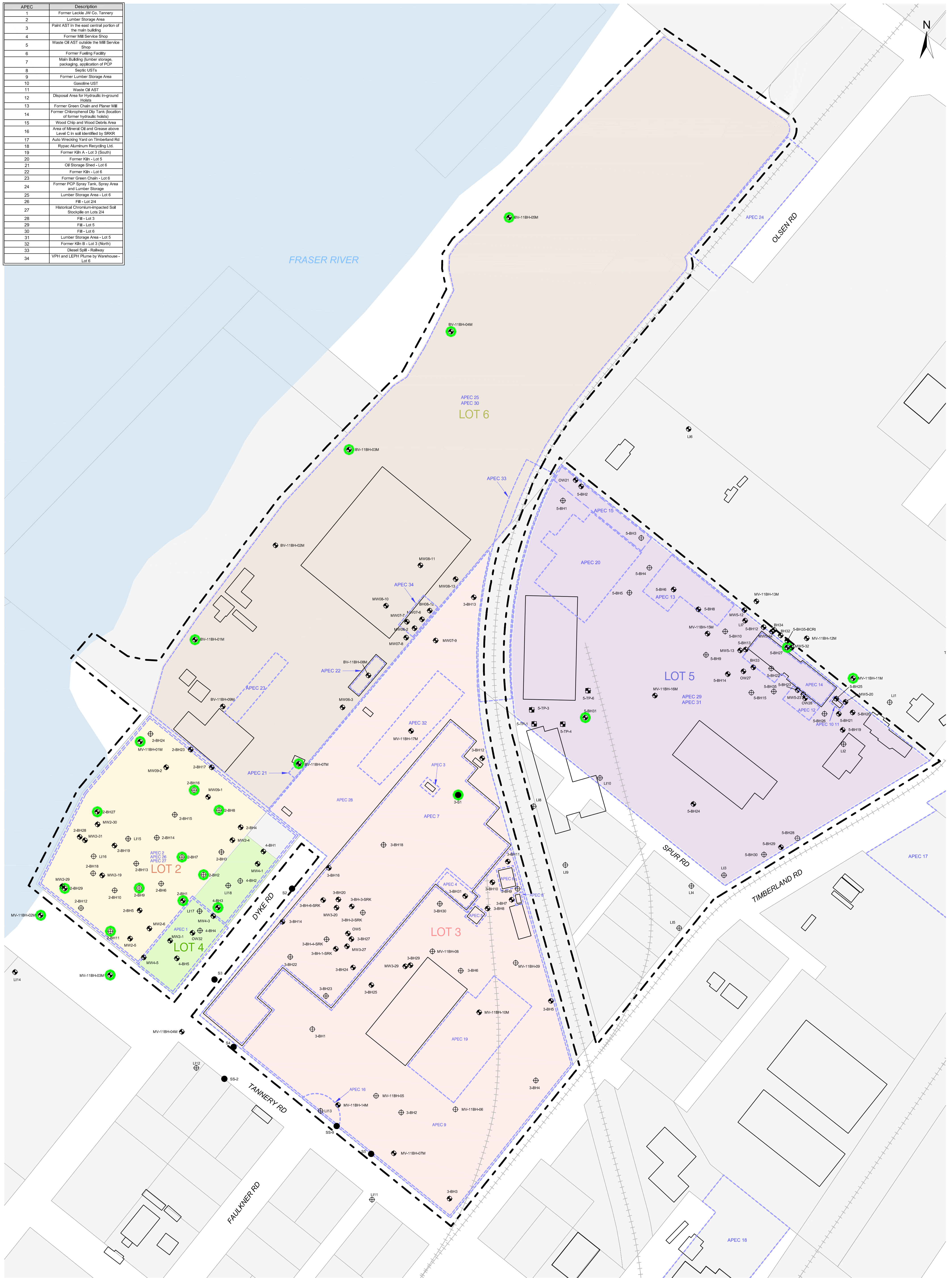

**LEGEND**

	Area of Potential Environmental Concern (APEC)		Lot 2
	Railway		Lot 3
	Site Boundary		Lot 4
	Existing Structure		Lot 5
	Property Boundary		Lot 6
	Test Pit		
	Borehole		
	Monitoring Well		
	Surface Soil Sample		

**NOTES**

- Coloured rings represent most recent sampling date.
- Refer to Tables for Full Soil Results.

	One or more analytical parameters are greater than the applicable BC CSR Soil Standards
	All analytical parameters are less than the applicable BC CSR Soil Standards
	One or more analytical parameters are greater than the applicable CCME Soil Standards
	All analytical parameters are less than the applicable CCME Soil Standards

**Scale 1:1000**

**Title: ANALYTICAL RESULTS - VOCs IN SOIL**

**Project: DATA GAP ANALYSIS SURREY-BROWNSVILLE, SURREY, BC**

**Client: VANCOUVER FRASER PORT AUTHORITY**

**Date: MAY 2013**

**FIGURE 8**

**FRANZ ENVIRONMENTAL INC.**  
CONSULTING • ENGINEERING • TECHNOLOGIES



APEC	Description
1	Former Leckie JW Co. Tannery
2	Lumber Storage Area
3	Paint AST in the east central portion of the main building
4	Former Mill Service Shop
5	Waste Oil AST outside the Mill Service Shop
6	Former Fueling Facility
7	Main Building (lumber storage, packaging, application of PCP)
8	Septic USTs
9	Former Lumber Storage Area
10	Gasoline UST
11	Waste Oil AST
12	Disposal Area for Hydraulic In-ground Hoses
13	Former Green Chain and Planer Mill
14	Former Chlorophenol Dip Tank (location of former hydraulic hoses)
15	Wood Chips and Wood Debris Area
16	Area of Mineral Oil and Grease above Level C in soil identified by SROR
17	Auto Wrecking Yard on Timberland Rd
18	Rypac Aluminum Recycling Ltd
19	Former K&H A - Lot 3 (South)
20	Former K&H - Lot 5
21	Oil Storage Shed - Lot 6
22	Former K&H - Lot 6
23	Former Green Chain - Lot 6
24	Former PCP Spray Tank, Spray Area and Lumber Storage
25	Lumber Storage Area - Lot 6
26	FB - Lot 2/4
27	Historical Chromium-impacted Soil Spoils on Lots 2/4
28	FB - Lot 3
29	FB - Lot 5
30	FB - Lot 6
31	Lumber Storage Area - Lot 5
32	Former K&H B - Lot 3 (North)
33	Diesel Spill - Railway
34	VPH and LEPH Plume by Warehouse - Lot 6

Area ID	Area Name	Color
1	Lot 2	Yellow
2	Lot 3	Pink
3	Lot 4	Green
4	Lot 5	Purple
5	Lot 6	Orange

Area ID	Area Name	Color
1	Lot 2	Yellow
2	Lot 3	Pink
3	Lot 4	Green
4	Lot 5	Purple
5	Lot 6	Orange

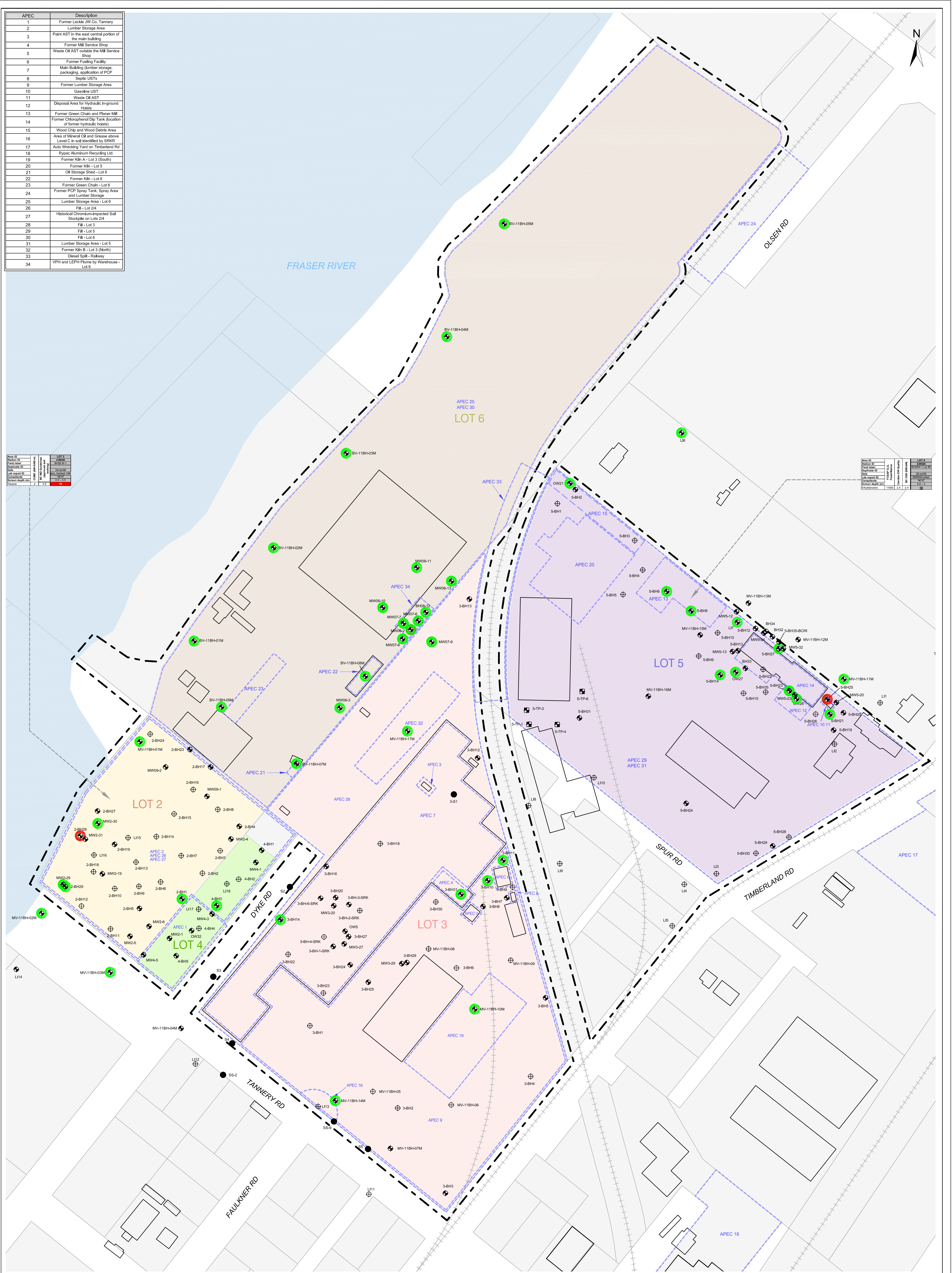

LEGEND	
	Area of Potential Environmental Concern (APEC)
	Railway
	Site Boundary
	Existing Structure
	Property Boundary
	Test Pit
	Borehole
	Monitoring Well
	Surface Soil Sample
	One or more analytical parameters are greater than the applicable FCSAP and Canadian DW Groundwater Standards
	All analytical parameters are less than the applicable FCSAP and Canadian DW Groundwater Groundwater Standards
	One or more analytical parameters are greater than the applicable BC CSR Groundwater Standards
	All analytical parameters are less than the applicable BC CSR Groundwater Standards
	Lot 2
	Lot 3
	Lot 4
	Lot 5
	Lot 6

**NOTES**  
 - All units in ug/L  
 - "-" indicates that there is no applicable standard or analyses were not performed.  
 - Red cells indicates parameter exceeds CCME (AW-fIAW-m). (Current as of 15-November-2012)  
 - Bold cells indicates parameter exceeds BC WQ Guidelines  
 - Coloured rings represent most recent sampling date.  
 - Refer to Tables for Full Groundwater Results.

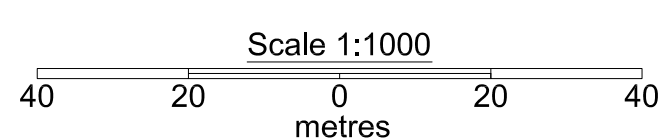

<b>ANALYTICAL RESULTS - MAHs IN GROUNDWATER</b>	
Project: DATA GAP ANALYSIS SURREY-BROWNSVILLE, SURREY, BC	
Client: VANCOUVER FRASER PORT AUTHORITY	
Date: MAY 2013	FIGURE 9

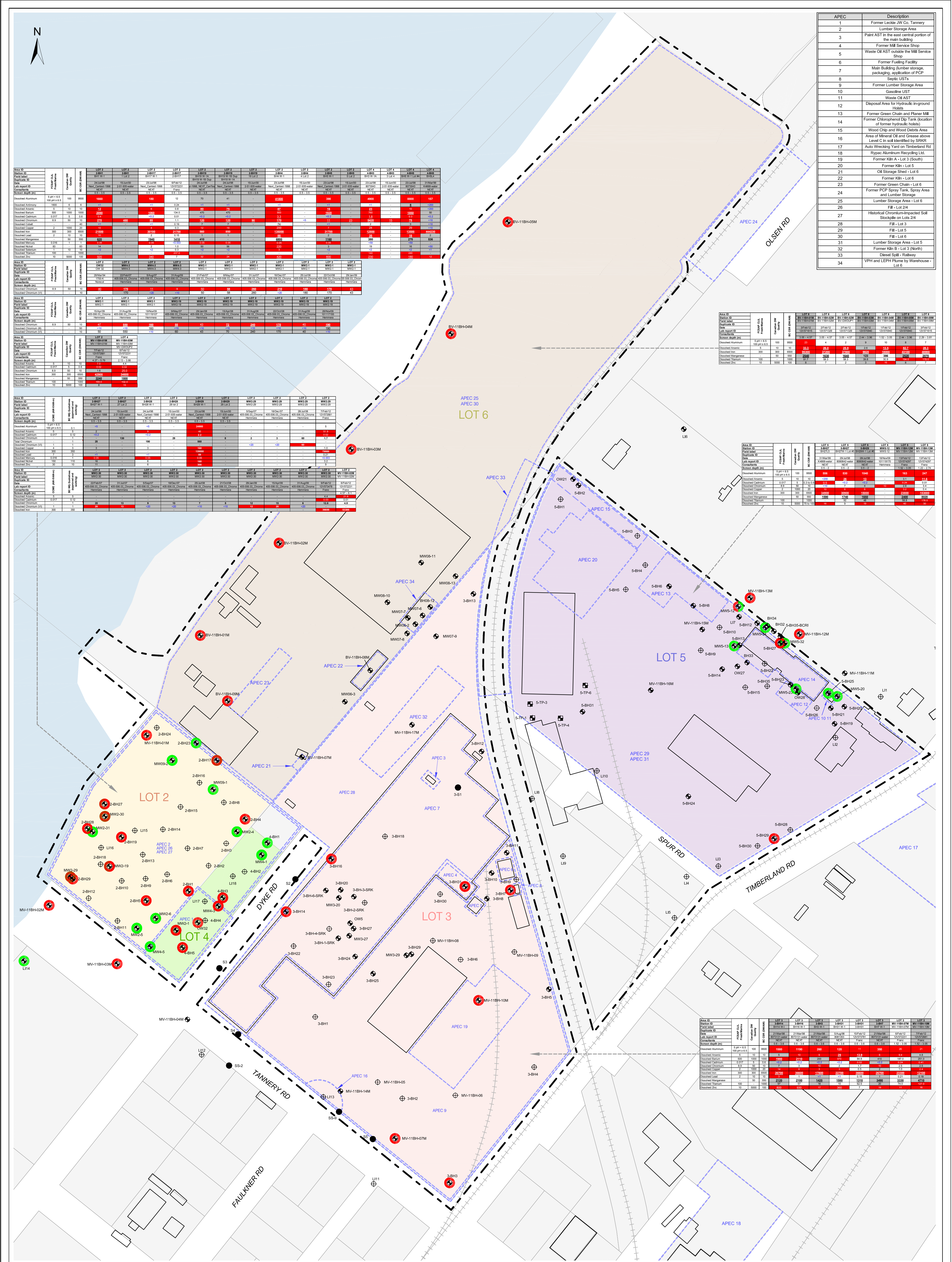

APEC	Description
1	Former Leckie JV Co. Tannery
2	Lumber Storage Area
3	Paint AST in the east central portion of the main building
4	Former Mill Service Shop
5	Waste Oil AST outside the Mill Service Shop
6	Former Fueling Facility
7	Main Building Lumber storage, packaging, application of PCP
8	Sepic USTs
9	Former Lumber Storage Area
10	Gasoline UST
11	Waste Oil AST
12	Disposal Area for Hydraulic In-ground Hobbs
13	Former Green Chain and Planer Mill
14	Former Chlorophenol Dip Tank (location of former hydraulic hobbs)
15	Wood Chip and Wood Debris Area
16	Area of Mineral Oil and Grease above Level C in soil identified by SRKR
17	Auto Wrecking Yard on Timberland Rd
18	Rytec Aluminum Recycling Ltd.
19	Former K&H A - Lot 3 (South)
20	Former K&H - Lot 5
21	Oil Storage Shed - Lot 6
22	Former K&H - Lot 6
23	Former Green Chain - Lot 6
24	Former PCP Spray Tank, Spray Area and Lumber Storage
25	Lumber Storage Area - Lot 6
26	Fill - Lot 2/4
27	Historical Chromium-impacted Soil Stockpile on Lots 2/4
28	Fill - Lot 3
29	Fill - Lot 5
30	Fill - Lot 6
31	Lumber Storage Area - Lot 5
32	Former K&H B - Lot 3 (North)
33	Diesel Spill - Railway
34	VPH and LEPH Plume by Warehouse - Lot 6

Area ID	Station ID	Depth (m)	Parameter	Result	Standard		
Area 1B	MV-11BH-01M	1.0	Aluminum	1668	100	1000	
			Antimony	180	6	100	
			Barium	2229	100	1000	
			Bismuth	15	1	100	
			Boron	12	1	100	
			Bromine	15	1	100	
			Calcium	15	1	100	
			Chromium	275	400	10	100
			Copper	2190	100	1000	
			Lead	12	1	100	
			Manganese	422	100	1000	
			Mercury	15	1	100	
Molybdenum	15	1	100				
Nickel	15	1	100				
Nitrate	15	1	100				
Selenium	15	1	100				
Silver	15	1	100				
Sulfate	15	1	100				
Sulfur	15	1	100				
Vanadium	15	1	100				
Zinc	15	1	100				

Area ID	Station ID	Depth (m)	Parameter	Result	Standard		
Area 1B	MV-11BH-01M	1.0	Aluminum	1668	100	1000	
			Antimony	180	6	100	
			Barium	2229	100	1000	
			Bismuth	15	1	100	
			Boron	12	1	100	
			Bromine	15	1	100	
			Calcium	15	1	100	
			Chromium	275	400	10	100
			Copper	2190	100	1000	
			Lead	12	1	100	
			Manganese	422	100	1000	
			Mercury	15	1	100	
Molybdenum	15	1	100				
Nickel	15	1	100				
Nitrate	15	1	100				
Selenium	15	1	100				
Silver	15	1	100				
Sulfate	15	1	100				
Sulfur	15	1	100				
Vanadium	15	1	100				
Zinc	15	1	100				

**LEGEND**

- Area of Potential Environmental Concern (APEC)
- Railway
- Site Boundary
- Existing Structure
- Property Boundary
- Test Pit
- Borehole
- Monitoring Well
- Surface Soil Sample

**NOTES**

- All units in ug/L
- "-" indicates that there is no applicable standard or analyses were not performed.
- Red cells indicates parameter exceeds FCSAP CLIL Fresh/Marine. (Current as of 9-November-2012.)
- Bold indicates parameter exceeds Candian DW Quality. (Current as of 9-November-2012.)
- Coloured rings represent most recent sampling date.
- Underline indicates parameter exceeds BC CSR (DW/AW). (Current as of 9-November-2012.)
- Refer to Tables for Full Groundwater Results.

Scale 1:1000

40 20 0 20 40 metres

**ANALYTICAL RESULTS - METALS IN GROUNDWATER**

DATA GAP ANALYSIS  
SURREY-BROWNSVILLE, SURREY, BC

VANCOUVER FRASER PORT AUTHORITY

Date: MAY 2013

FIGURE 10

APEC	Description
1	Former Leckie JW Co. Tannery
2	Lumber Storage Area
3	Paint AST in the east central portion of the main building
4	Former Mill Service Shop
5	Waste Oil AST outside the Mill Service Shop
6	Former Fueling Facility
7	Main Building (lumber storage, packaging, application of PCP)
8	Septic USTs
9	Former Lumber Storage Area
10	Gasoline UST
11	Waste Oil AST
12	Disposal Area for Hydraulic In-ground Hoses
13	Former Green Chain and Planer Mill
14	Former Chlorophenol Dip Tank (location of former hydraulic hoses)
15	Wood Chips and Wood Debris Area
16	Area of Mineral Oil and Grease above Level C in soil identified by SROR
17	Auto Wrecking Yard on Timberland Rd
18	Rypac Aluminum Recycling Ltd
19	Former K&H A - Lot 3 (South)
20	Former K&H - Lot 5
21	Oil Storage Shed - Lot 6
22	Former K&H - Lot 6
23	Former Green Chain - Lot 6
24	Former PCP Spray Tank, Spray Area and Lumber Storage
25	Lumber Storage Area - Lot 6
26	FB - Lot 2/4
27	Historical Chromium-impacted Soil Spoils on Lots 2/4
28	FB - Lot 3
29	FB - Lot 5
30	FB - Lot 6
31	Lumber Storage Area - Lot 5
32	Former K&H B - Lot 3 (North)
33	Diesel Spill - Railway
34	VPH and LEPH Plume by Warehouse - Lot 6

Area ID	Station ID	Depth (m)	Parameter	Value	Unit	Standard	Notes
LOT 2	MW2-30	1.5	PAHs	1.2	ug/L	CCME	Exceeds
LOT 2	MW2-31	1.5	PAHs	0.8	ug/L	CCME	Complies
LOT 2	MW2-19	1.5	PAHs	0.5	ug/L	CCME	Complies
LOT 2	MW2-5	1.5	PAHs	0.3	ug/L	CCME	Complies
LOT 2	MW2-4	1.5	PAHs	0.2	ug/L	CCME	Complies
LOT 2	MW2-3	1.5	PAHs	0.1	ug/L	CCME	Complies
LOT 2	MW2-2	1.5	PAHs	0.1	ug/L	CCME	Complies
LOT 2	MW2-1	1.5	PAHs	0.1	ug/L	CCME	Complies
LOT 2	MW2-0	1.5	PAHs	0.1	ug/L	CCME	Complies
LOT 2	MW2-30	1.5	PAHs	1.2	ug/L	CCME	Exceeds
LOT 2	MW2-31	1.5	PAHs	0.8	ug/L	CCME	Complies
LOT 2	MW2-19	1.5	PAHs	0.5	ug/L	CCME	Complies
LOT 2	MW2-5	1.5	PAHs	0.3	ug/L	CCME	Complies
LOT 2	MW2-4	1.5	PAHs	0.2	ug/L	CCME	Complies
LOT 2	MW2-3	1.5	PAHs	0.1	ug/L	CCME	Complies
LOT 2	MW2-2	1.5	PAHs	0.1	ug/L	CCME	Complies
LOT 2	MW2-1	1.5	PAHs	0.1	ug/L	CCME	Complies
LOT 2	MW2-0	1.5	PAHs	0.1	ug/L	CCME	Complies

Area ID	Station ID	Depth (m)	Parameter	Value	Unit	Standard	Notes
LOT 5	MV-11BH-13M	1.5	PAHs	1.5	ug/L	CCME	Exceeds
LOT 5	MV-11BH-12M	1.5	PAHs	1.2	ug/L	CCME	Exceeds
LOT 5	MV-11BH-11M	1.5	PAHs	0.8	ug/L	CCME	Complies
LOT 5	MV-11BH-10M	1.5	PAHs	0.5	ug/L	CCME	Complies
LOT 5	MV-11BH-9M	1.5	PAHs	0.3	ug/L	CCME	Complies
LOT 5	MV-11BH-8M	1.5	PAHs	0.2	ug/L	CCME	Complies
LOT 5	MV-11BH-7M	1.5	PAHs	0.1	ug/L	CCME	Complies
LOT 5	MV-11BH-6M	1.5	PAHs	0.1	ug/L	CCME	Complies
LOT 5	MV-11BH-5M	1.5	PAHs	0.1	ug/L	CCME	Complies
LOT 5	MV-11BH-4M	1.5	PAHs	0.1	ug/L	CCME	Complies
LOT 5	MV-11BH-3M	1.5	PAHs	0.1	ug/L	CCME	Complies
LOT 5	MV-11BH-2M	1.5	PAHs	0.1	ug/L	CCME	Complies
LOT 5	MV-11BH-1M	1.5	PAHs	0.1	ug/L	CCME	Complies
LOT 5	MV-11BH-13M	1.5	PAHs	1.5	ug/L	CCME	Exceeds
LOT 5	MV-11BH-12M	1.5	PAHs	1.2	ug/L	CCME	Exceeds
LOT 5	MV-11BH-11M	1.5	PAHs	0.8	ug/L	CCME	Complies
LOT 5	MV-11BH-10M	1.5	PAHs	0.5	ug/L	CCME	Complies
LOT 5	MV-11BH-9M	1.5	PAHs	0.3	ug/L	CCME	Complies
LOT 5	MV-11BH-8M	1.5	PAHs	0.2	ug/L	CCME	Complies
LOT 5	MV-11BH-7M	1.5	PAHs	0.1	ug/L	CCME	Complies
LOT 5	MV-11BH-6M	1.5	PAHs	0.1	ug/L	CCME	Complies
LOT 5	MV-11BH-5M	1.5	PAHs	0.1	ug/L	CCME	Complies
LOT 5	MV-11BH-4M	1.5	PAHs	0.1	ug/L	CCME	Complies
LOT 5	MV-11BH-3M	1.5	PAHs	0.1	ug/L	CCME	Complies
LOT 5	MV-11BH-2M	1.5	PAHs	0.1	ug/L	CCME	Complies
LOT 5	MV-11BH-1M	1.5	PAHs	0.1	ug/L	CCME	Complies

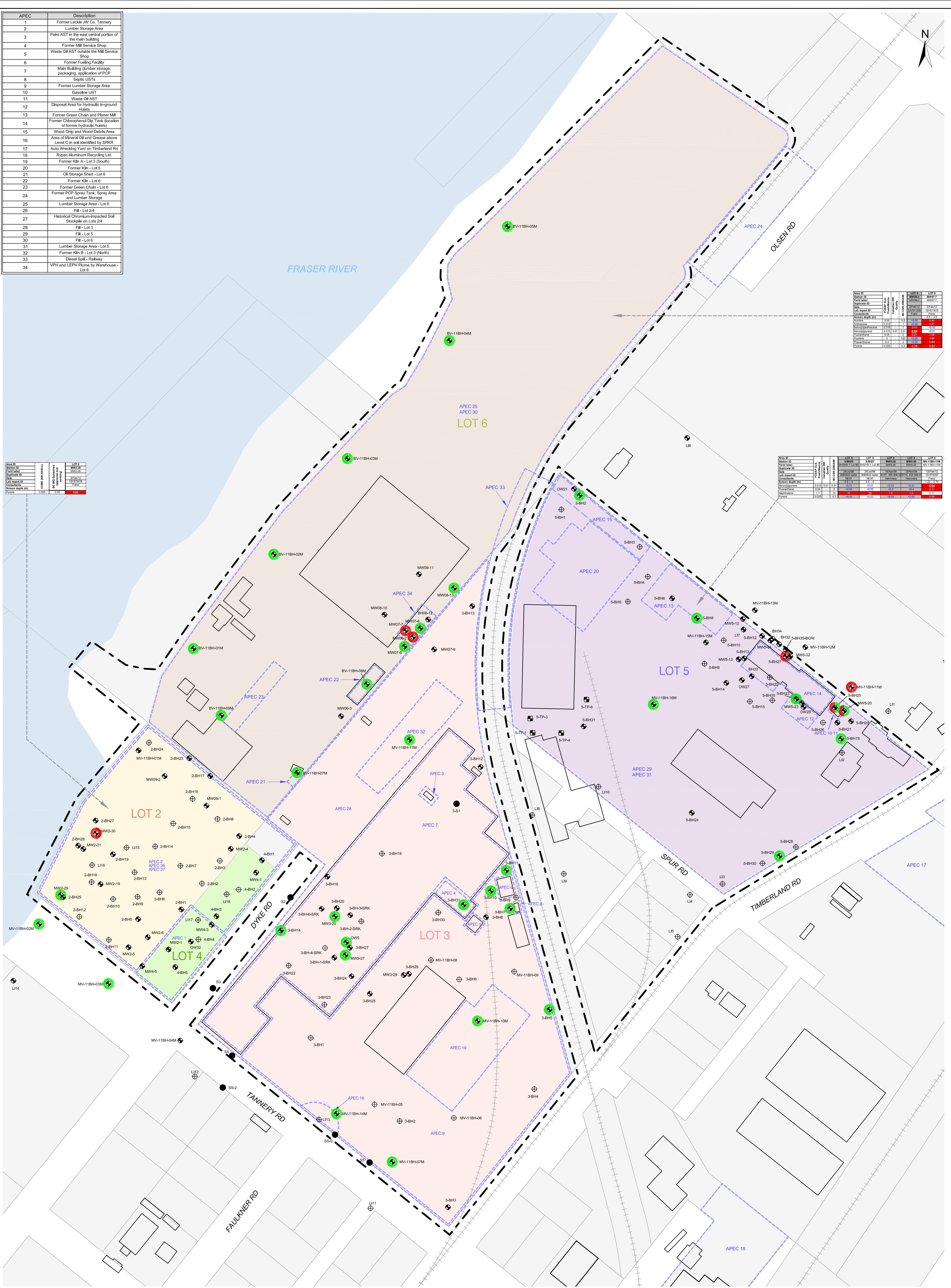

**LEGEND**

- Area of Potential Environmental Concern (APEC)
- Railway
- Site Boundary
- Existing Structure
- Property Boundary
- Test Pit
- Borehole
- Monitoring Well
- Surface Soil Sample

● One or more analytical parameters are greater than the applicable FCSAP and Canadian DW Groundwater Standards  
● All analytical parameters are less than the applicable FCSAP and Canadian DW Groundwater Standards  
● One or more analytical parameters are greater than the applicable BC CSR Groundwater Standards  
● All analytical parameters are less than the applicable BC CSR Groundwater Standards

Lot 2  
 Lot 3  
 Lot 4  
 Lot 5  
 Lot 6

**NOTES**

- All units in ug/L
- "-" indicates that there is no applicable standard or analyses were not performed.
- Red cells indicates parameter exceeds CCME (AW-fIAW-m). (Current as of 15-November-2012)
- Bold cells indicates parameter exceeds BC WQ Guidelines
- Coloured rings represent most recent sampling date.
- Refer to Tables for Full Groundwater Results.

Scale 1:1000

40 20 0 20 40 metres

Title: **ANALYTICAL RESULTS - PAHs IN GROUNDWATER**

Project: **DATA GAP ANALYSIS SURREY-BROWNSVILLE, SURREY, BC**

Client: **VANCOUVER FRASER PORT AUTHORITY**

Date: **MAY 2013**

**FIGURE 11**

FRANZ ENVIRONMENTAL INC.  
CONSULTING • ENGINEERING • TECHNOLOGIES

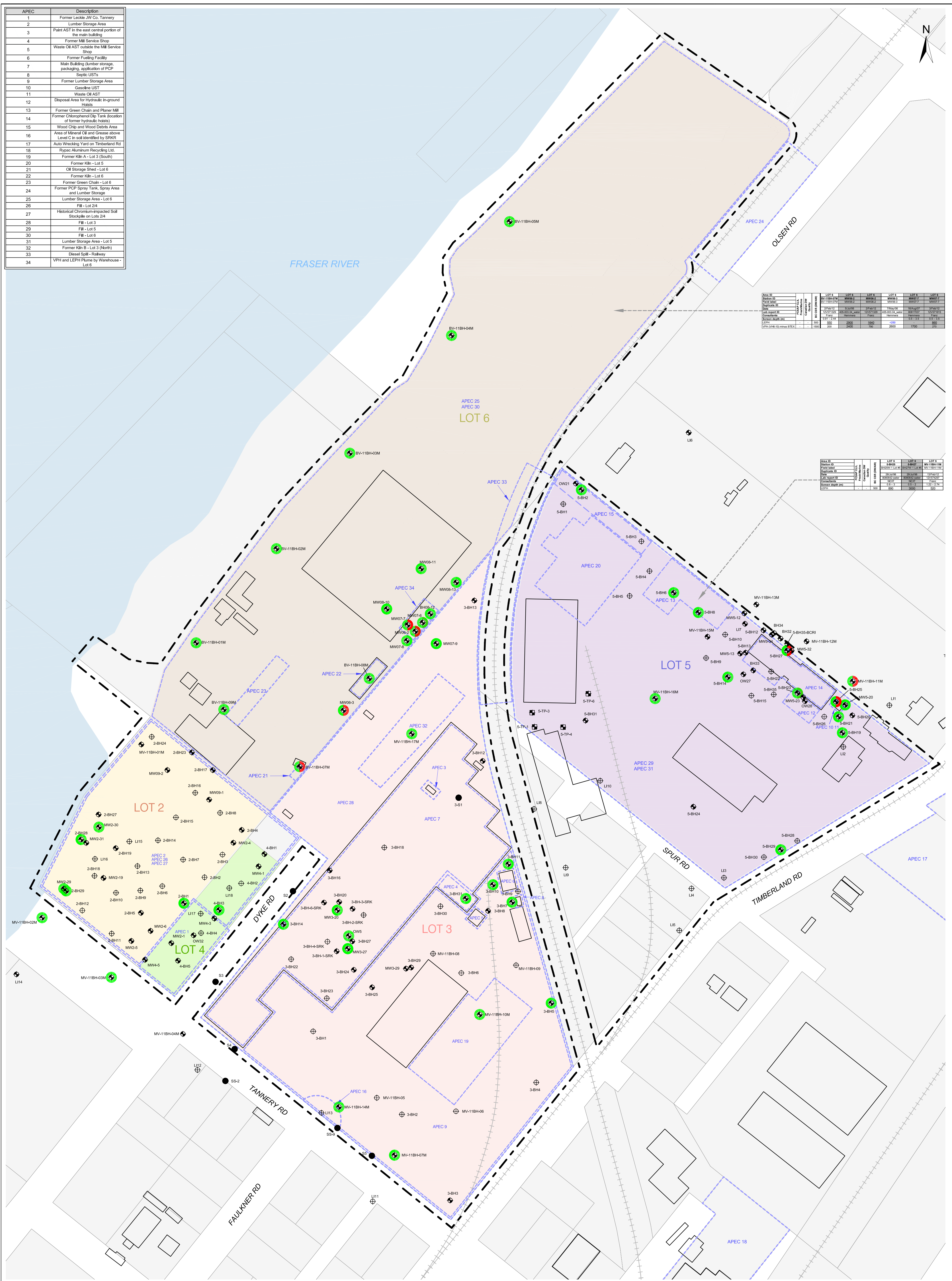

APEC	Description
1	Former Leckie JW Co. Tannery
2	Lumber Storage Area
3	Paint AST in the east corner portion of the main building
4	Former Mill Service Shop
5	Waste Oil AST outside the Mill Service Shop
6	Former Fueling Facility
7	Main Building (lumber storage, packaging, application of PCP)
8	Septic USTs
9	Former Lumber Storage Area
10	Gasoline UST
11	Waste Oil AST
12	Disposal Area for Hydraulic In-ground Hoists
13	Former Green Chain and Planer Mill
14	Former Chlorophenol Dip Tank (location of former hydraulic hoists)
15	Wood Chips and Wood Debris Area
16	Area of Mineral Oil and Grease above Level C in soil identified by SROR
17	Auto Wrecking Yard on Timberland Rd
18	Rypac Aluminum Recycling Ltd
19	Former Kib A - Lot 3 (South)
20	Former Kib - Lot 5
21	Oil Storage Shed - Lot 6
22	Former Kib - Lot 6
23	Former Green Chain - Lot 6
24	Former PCP Spray Tank, Spray Area and Lumber Storage
25	Lumber Storage Area - Lot 6
26	FB - Lot 2/4
27	Historical Chromium-impacted Soil Spoils on Lots 2/4
28	FB - Lot 3
29	FB - Lot 5
30	FB - Lot 6
31	Lumber Storage Area - Lot 5
32	Former Kib B - Lot 3 (North)
33	Diesel Spill - Railway
34	VPH and LEPH Plume by Warehouse - Lot 6

Area ID	Area Name	Area Type	Area Code	Area Status	Area Date
LOT 2	LOT 2	LOT 2	LOT 2	LOT 2	LOT 2
LOT 3	LOT 3	LOT 3	LOT 3	LOT 3	LOT 3
LOT 4	LOT 4	LOT 4	LOT 4	LOT 4	LOT 4
LOT 5	LOT 5	LOT 5	LOT 5	LOT 5	LOT 5
LOT 6	LOT 6	LOT 6	LOT 6	LOT 6	LOT 6

Area ID	Area Name	Area Type	Area Code	Area Status	Area Date
LOT 2	LOT 2	LOT 2	LOT 2	LOT 2	LOT 2
LOT 3	LOT 3	LOT 3	LOT 3	LOT 3	LOT 3
LOT 4	LOT 4	LOT 4	LOT 4	LOT 4	LOT 4
LOT 5	LOT 5	LOT 5	LOT 5	LOT 5	LOT 5
LOT 6	LOT 6	LOT 6	LOT 6	LOT 6	LOT 6

**LEGEND**

- Area of Potential Environmental Concern (APEC)
- Railway
- Site Boundary
- Existing Structure
- Property Boundary
- Test Pit
- Borehole
- Monitoring Well
- Surface Soil Sample

**Color Key:**

- Lot 2
- Lot 3
- Lot 4
- Lot 5
- Lot 6

**Symbol Key:**

- C One or more analytical parameters are greater than the applicable FCSAP and Canadian DW Groundwater Standards
- C All analytical parameters are less than the applicable FCSAP and Canadian DW Groundwater Standards
- C One or more analytical parameters are greater than the applicable BC CSR Groundwater Standards
- C All analytical parameters are less than the applicable BC CSR Groundwater Standards

**NOTES**

- All units in ug/L
- "-" indicates that there is no applicable standard or analyses were not performed.
- Red cells indicates parameter exceeds FCSAP CLIL Fresh/Marine. (Current as of 9-November-2012)
- Bold indicates parameter exceeds Canadian DW Quality. (Current as of 9-November-2012)
- Coloured rings represent most recent sampling date.
- Underline indicates parameter exceeds BC CSR (DW/AW). (Current as of 9-November-2012)
- Refer to Tables for Full Groundwater Results.

Scale 1:1000

40    20    0    20    40  
metres

**Title:** ANALYTICAL RESULTS - PHCs IN GROUNDWATER

**Project:** DATA GAP ANALYSIS SURREY-BROWNSVILLE, SURREY, BC

**Client:** VANCOUVER FRASER PORT AUTHORITY

**Date:** MAY 2013

**FIGURE 12**

2090-1103/CAD/CBI/Analytical Posters.dwg